

COMPONENTS MIXERS

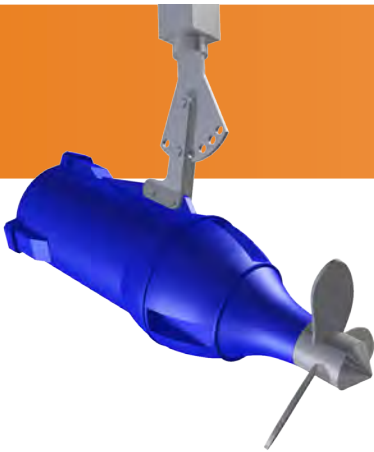

FEATURES

The HYFLOW® Commercial submersible mixers have been constructed for the most demanding applications. Typically used to agitate liquids in wastewater or process applications.

MIXER:

- > Heavy duty cast iron construction
- > Heavy duty 316 stainless steel propeller
- > 176mm diameter impeller
- > Drive end double row ball bearing
- > Hardface mechanical shaft seal in a large capacity oil chamber
- > Stainless steel heavy rigid shaft for increased seal and long life
- > 10 Metre power cable, HO7RFN submersible rubber cable
- > Class H motor windings
- > 50mm BSPF fixing
- > Mounting clamp with adjustable angle positioning

AUTO COUPLING

- > Stainless steel components to enable floor mounting

SUSPENDED MOUNTING (MAXIMUM 2M DEPTH & STRUCTURALLY SOUND MOUNTING SURFACE REQUIRED)

- > Stainless steel components to enable suspended mounting from top of pit



25 YEARS INDUSTRY EXPERIENCE

RANGE

MODEL	PRODUCT CODE	IMPELLER	VOLTAGE	POWER	LOAD CURRENT	WEIGHT
HSM.176.07.3.4	190200	176mm	415	0.7kW	1.5 Amps	20 kg

NOTE

1. For full motor protection, mixers must be protected by a manually resettable thermal overload device

MODEL	PRODUCT CODE	INCLUSIONS
HSM.AC (Auto Coupling)	190201	ITEM 1: Stainless Steel support bracket ITEM 2: Stainless Steel floor positioning guide rail bracket ITEM 3: Stainless Steel top positioning guide rail bracket ITEM 4: 65 x 65 x 3 guide rail (Not included)
HSM.SM (Suspended Mounting)	190202	ITEM 1: Stainless Steel top mounting bracket ITEM 2: 50mm BSPM Support pipe (Not included)

PERFORMANCE

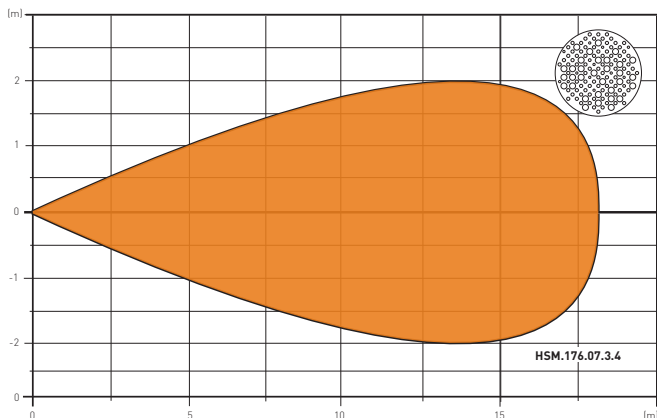

TYPICAL ARRANGEMENT

AUTO COUPLING (HSM.AC)

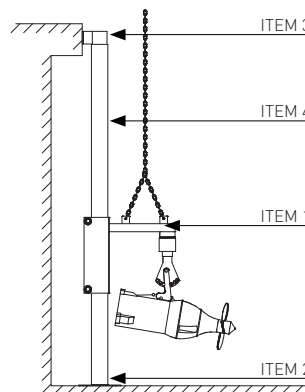

SUSPENDED MOUNT (HSM.SM)

