

# PACKAGE PUMP STATIONS VALVE CHAMBERS

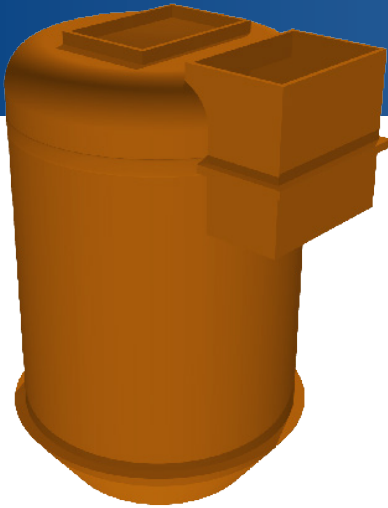

## FEATURES

The FRP Valve Chambers enable the servicing and maintenance of the valves without the need for confined space entry into the pump station. This greatly improves safety and reduces ongoing overhead costs.

- > Contains all non return and isolation valves
- > Optional one way valve to redirect any water from valve chamber, back into pump station

### INTEGRAL VALVE CHAMBER:

- > One piece integration with pit for easy installation



## 30 YEARS INDUSTRY EXPERIENCE

RANGE	VALVE CHAMBER SIZE	WIDTH (W)	DEPTH (D)	HEIGHT (H)
INTEGRAL	0.6m x 0.6m	0.63m	0.63m	0.6m
	0.9m x 0.9m	0.93m	0.93m	0.9m
	1.2m x 1.2m	1.2m	1.2m	1.2m

### NOTES

1. Not all valve chamber sizes can be fitted to our pump station range. Refer to the table below for compatibility
2. Commissioning is available to carry out start procedures, set levels and verify performance

## PIT COMPATIBILITY

	VALVE CHAMBER SIZE	PUMP STATION SIZES		
		1.2M DIA	1.5M DIA	1.8M DIA
INTEGRAL	0.6m x 0.6m	✓	✓	✓
	0.9m x 0.9m	✗	✓	✓
	1.2m x 1.2m	✗	✓	✓

## TYPICAL ARRANGEMENT

