

# HYLIFT® UNDERSINK SULLAGE PUMPS WATER SUPPLY INTERLOCK



## FEATURES

The All Purpose Pumps Water Supply Interlock shuts off water supply in the event of a high level warning and pump failure.

- > Ideal for all Domestic or Commercial applications
- > Maximum operating temperature - 80 °C
- > Maximum operating pressure 1200 kPa
- > Voltage free common alarm output for BMS connection



**25 YEARS** INDUSTRY EXPERIENCE

## RANGE

MODEL	PRODUCT CODE	DESCRIPTION	POWER SUPPLY	SOLENOID PORTS
HYLIFT-SI	865022	Solenoid Interlock Device	10A GPO (240v)	20mm BSP M
HYLIFT-2SI	865026	Solenoid Valve Interlock Device (2 x solenoids)	10A GPO (240v)	20mm BSP M

### NOTE

1. All interlock devices must be connected to a High Level Alarm Device

## TYPICAL ARRANGEMENT

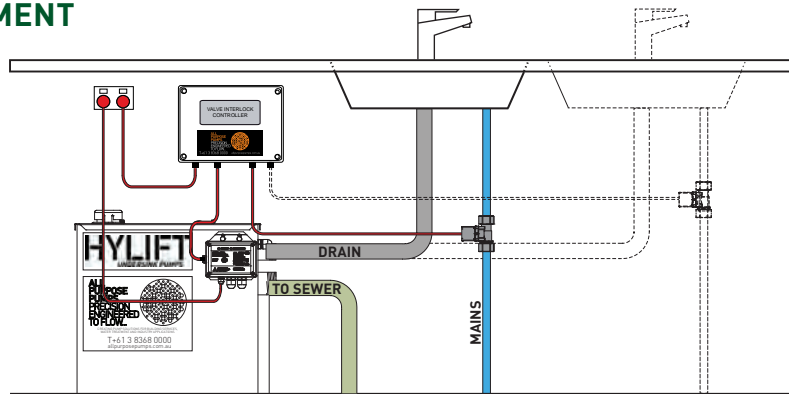

## DIMENSIONS

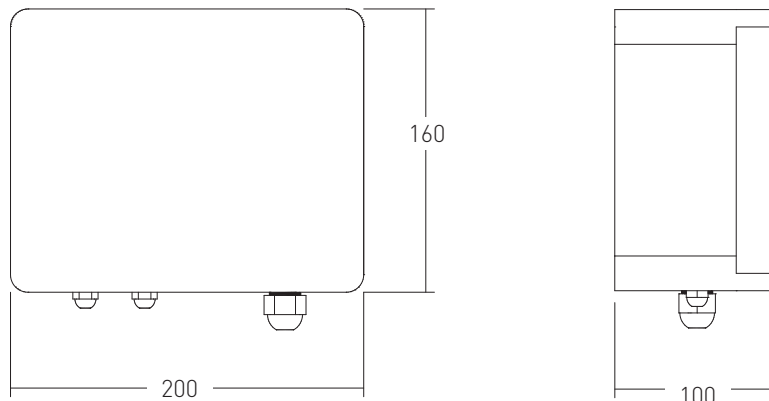

### NOTE

1. All dimensions are in mm and are approximate

